

Spring Birthdays - September Start Timetable for New Year R Children

St Mark's CofE Primary School



Dear Parents,

We're pleased to have a plan for your child starting at St Mark's in September! Thank you for bearing with us in the delay of getting this to you. It's been a challenge as we not only review the arrangements for the whole school, but also for our new Year R children.

Staggered Starts & Phased Transition - Why?!

In normal years for children starting in Year R, we run a two-week phased transition period. This allows children to start school in smaller chunks of time, and also with smaller groups of children. It really makes a positive difference for all children. As the two weeks go on, children are in school for longer periods of time, until all children are in full time at the start of the third week.

Because of Covid-19, there is an extra complication! We have to stagger our start and finish times for the whole school as having 650 children and their adults is too much in one go. Therefore, we are running a staggered morning arrival times and afternoon collection times by surname.

Please remember that the timetable below also dovetails into the timetables for Spring and Summer born children, so it is quite complicated! Generally, Autumn children become settled first and stay for lunch earlier.

What if I have to go to work full time from day one?

We do ask that you work with your employer to be flexible with the timetable below. It really does help your child - and the other children - because of the smaller groupings. If it is completely impossible for you, please do get in touch and we can discuss solutions.

Where do I go?

- Please enter the site at the KS1 gate, which is the Hatch Warren Community Centre side of the school (accessible via Woodbury Road).
- Please exit at the Dandelions gate. Once your child is full time, if you are also collecting a sibling after 2:55pm, you may exit via the KS2 gate - please collect your Year R child first.
- When your child is full time, the map below will also apply:

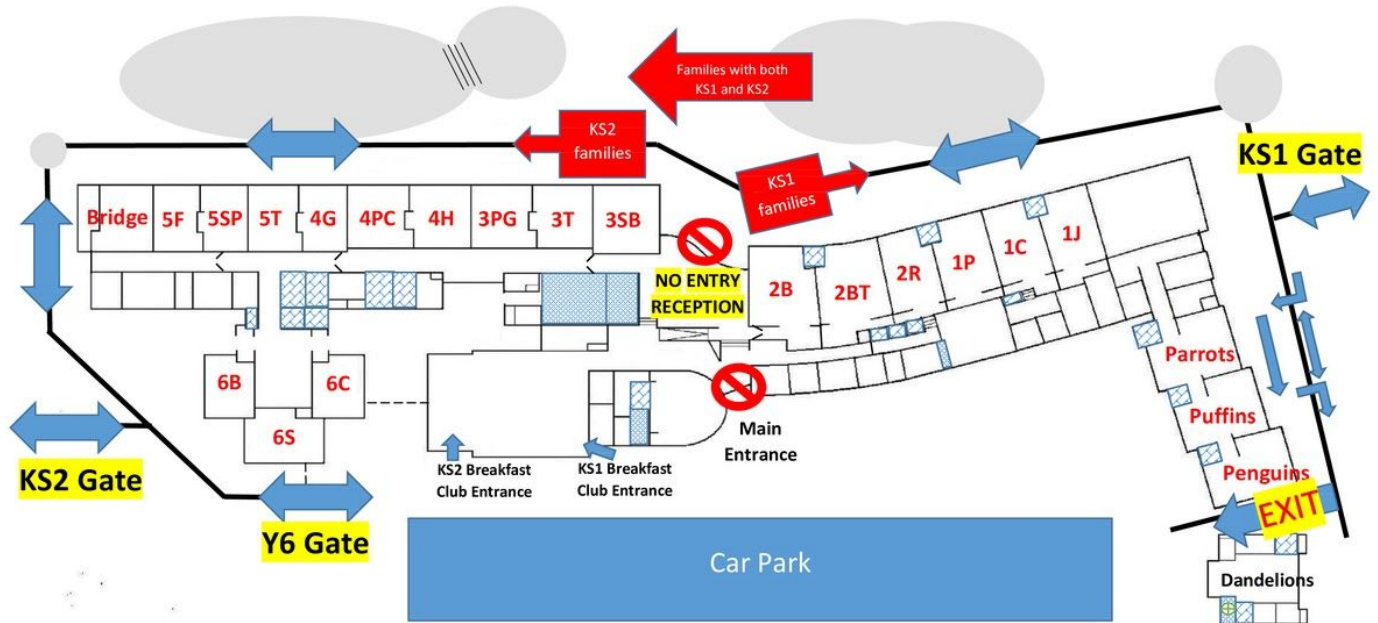

How do I enter and exit the school site?

- If you only have a Year R child, please enter at the KS1 gate and leave via the Dandelions exit.
- If you have a child or children in KS1 only, please use only the KS1 gate for entering and exiting.
- If you have a child or children in KS2 only, please use on the KS2 gate for entering and exiting.
- If you have children in both KS1 and KS2, please enter via the KS1 gate and leave via the KS2 gate (i.e. a one-way system).
- If your child is in Year 6, please have them enter and exit via the Year 6 gate, to ease congestion at the KS2 gate. They can do this independently.

Arrival and collection times are staggered:

Arrival by child's surname	A-F: 8:30-8:40am	G-M: 8:40-8:50	N-Z: 8:50-9:00
Collection by Surname	A-F: 2:55-3:05pm	G-M: 3:05-3:15pm	N-Z: 3:15pm-3:20pm

What is the timetable for the first two weeks of September? (Remember, the 3rd & 4th Sept are INSET days)

SPRING (Children born between 1st January 2016 - 30th April 2016)

Week 1	Monday 7th	Tuesday 8th	Weds 9th	Thurs 10th	Friday 11th
Arrival Time	Not in Monday morning	Arrival by Surname - A-F: 8:30-8:40, G-M 8:40-8:50 , N-Z 8:50-9:00			
Staying for lunch?	No	No. Collect at 11.30am	No. Collect at 11.30am	Yes. Collect at 12:25pm	Yes. Collect at 12:25pm
Afternoon Arrival	1:15pm	Not in	Not in	Not in	Not in
Afternoon Collection	3:15pm	Not in	Not in	Not in	Not in

Week 2	Monday 14th	Tuesday 15th	Weds 16th	Thurs 17th	Friday 18th
Arrival Time	Arrival by Surname - A-F: 8:30-8:40, G-M 8:40-8:50 , N-Z 8:50-9:00				
Staying for lunch?	Yes. Collect at 12:40pm	Yes. Collect at 12:40pm	Yes	Yes	Yes

Afternoon Arrival	Not in	Not in	Saying all day	Saying all day	Saying all day
Afternoon Collection	Not in	Not in	Collection by Surname - A-F: 2:55-3:05pm, G-M: 3:05-3:15pm, N-Z 3:15pm-3:20pm		

Week 3 onwards - full time

Arrival by Surname - A-F: 8:30-8:40, G-M 8:40-8:50 , N-Z 8:50-9:00

Collection by Surname - A-F: 2:55-3:05pm, G-M: 3:05-3:15pm, N-Z 3:15pm-3:20pm

School Uniform

We are excited to say that children must wear their school uniform. On the days that children have their PE lessons, we are asking them to come in wearing their PE kit all day, and not their uniform. This is because it reduces the need to support children with their changing (a safety precaution for all).

Lunches

On the days that they stay for lunch, the children can bring in a packed lunch or can order their universal free school meal (all Year R and KS1 children are entitled to) which is a meat or vegetarian option.

Snack & Milk

At present, we are unsure if the free fruit and milk from the government will be running. Our advice is to send a piece of fruit with your child. We will be in touch when we know more.

Regarding Milk, you will need to self-register at www.coolmilk.com if you haven't already done so. This is for your child to receive a free carton of milk each day, when it is up and running. In the meantime, please bring a water bottle.

Books bags

Children can bring in a small book bag, although we are asking children to bring in as little as needed.

Soap, Handwashing, Sunscreen and Wellies

The children will be washing their hands a lot!! If you would prefer your child to use specialist soap, please send this in with your child. It can be left at school. It must have their name on it, and be completed nut-free. On hot days, please apply sunscreen before school, as we will not be able to apply it during the day. Wellies can be brought in and stored at school on the wellie-rack.

School Office/Reception

We are asking parents to refrain from coming into the office area. Please do email or call instead. Thank you.

SCL Wraparound Care - After School Club

This will be running, and can be booked by going to www.stmarksprimary.net/sc

St Mark's own breakfast club will also be running. Pre-booking will be necessary, but this is only to help with the admin side of the club. More information will be given out about this soon.

Summary!

Finally, a helpful summary of starting at St Mark's can be found [here](#).

As always, if you have any questions, please do contact us at newyearsept2020@stmarksce.org.uk. We look forward to meeting your child in September!

Best wishes,

Mr Applegate & the St Mark's Team